

Judkins Park Station Tour

Joint Transportation Committee

9/24/2024



Sound Transit District

Serving a region of more than 3 million

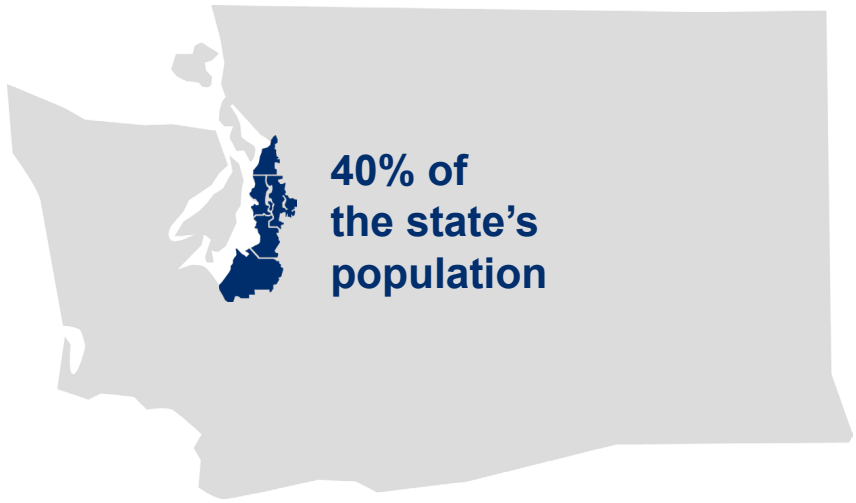

Link light rail
 1 2 T
 Sounder trains
 N S
 ST Express bus



Current system

Link light rail 1 2 T

- Three lines
- 44 miles
- 44 stations
- Connecting Lynnwood–Angle Lake, Redmond Technology–South Bellevue, Tacoma Dome–St Joseph

Sounder trains N S

- Two lines
- 83 miles
- 12 stations
- Connecting Everett–Seattle and Lakewood–Seattle

ST Express buses

- 24 express routes on regional freeway corridors



East Link and Downtown Redmond Opens 2024-2025*

- When fully open, the new 2 Line will run from Lynnwood–Downtown Redmond, serving 26 stations and over 34 miles of track.
- Opening in phases:
 - South Bellevue–Redmond Tech. (Opened April 2024).
 - Lynnwood–Downtown Redmond (2025).
- 12 *new* stations in Seattle (1), Mercer Island (1), Bellevue (6), and Redmond (4).



Link light rail

2 2 Line extension to Lynnwood (in construction)

Other service:

1 1 Line Lynnwood–Angle Lake (current)

2 2 Line Redmond Technology–South Bellevue (current)

2 2 Line Lynnwood–Downtown Redmond (future)

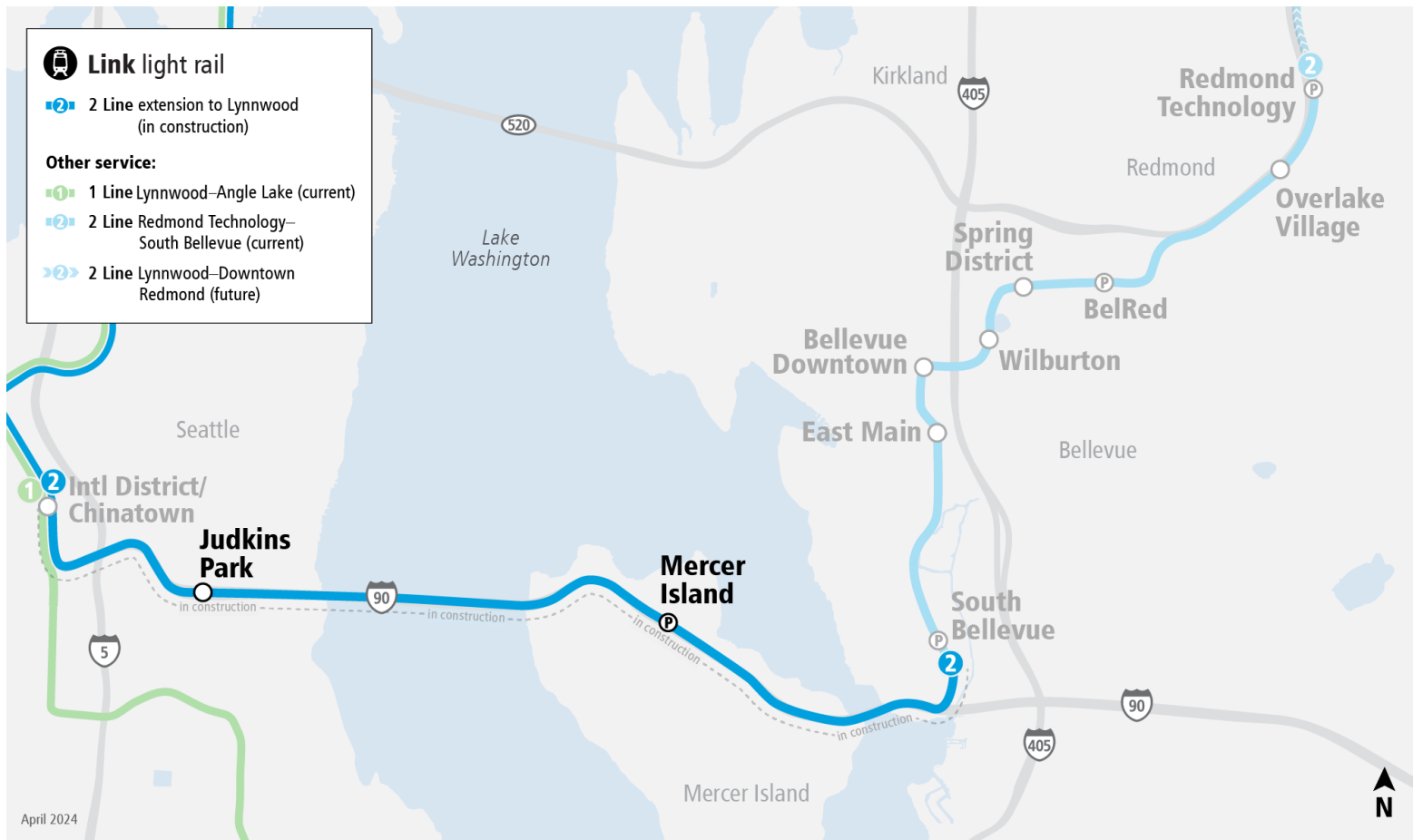

April 2024

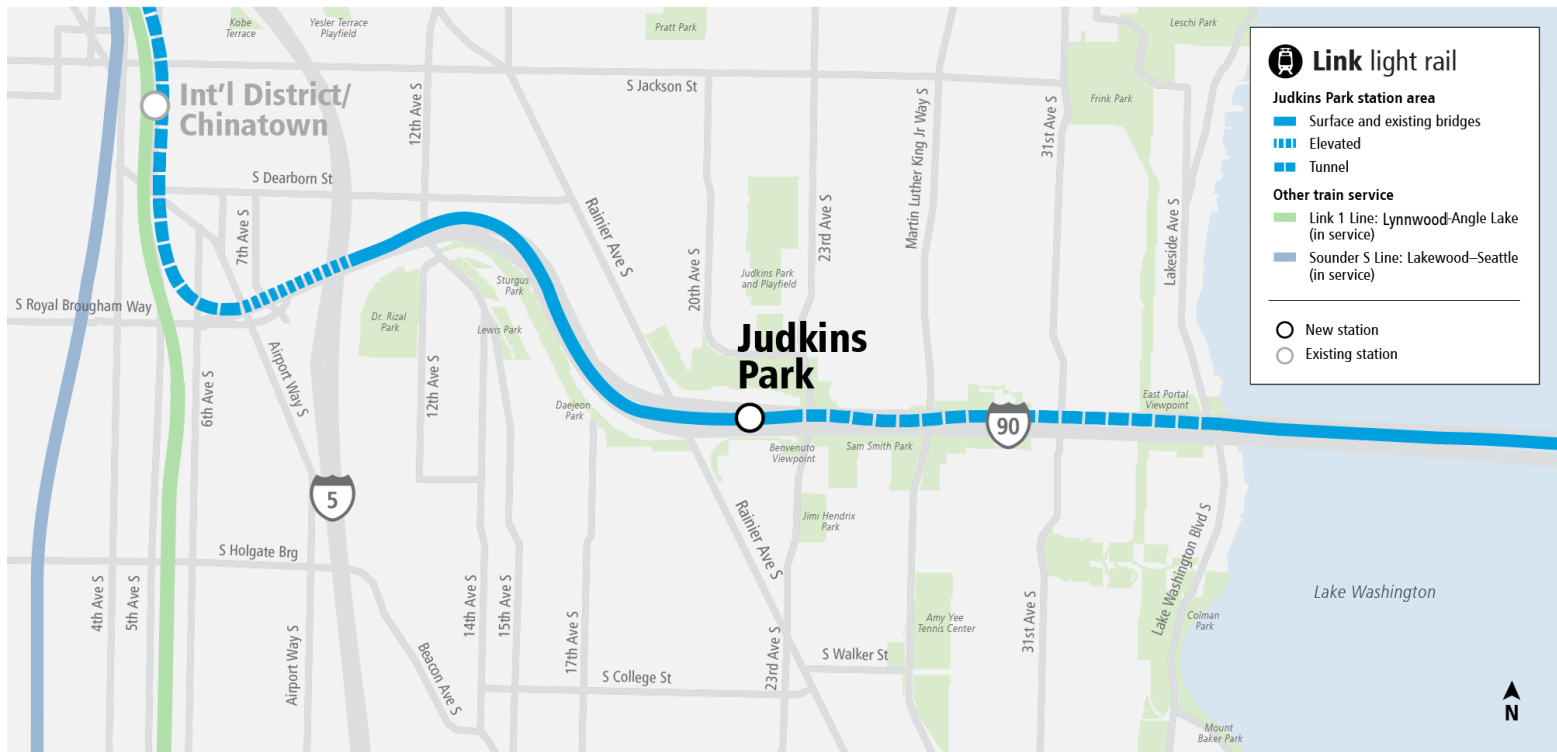

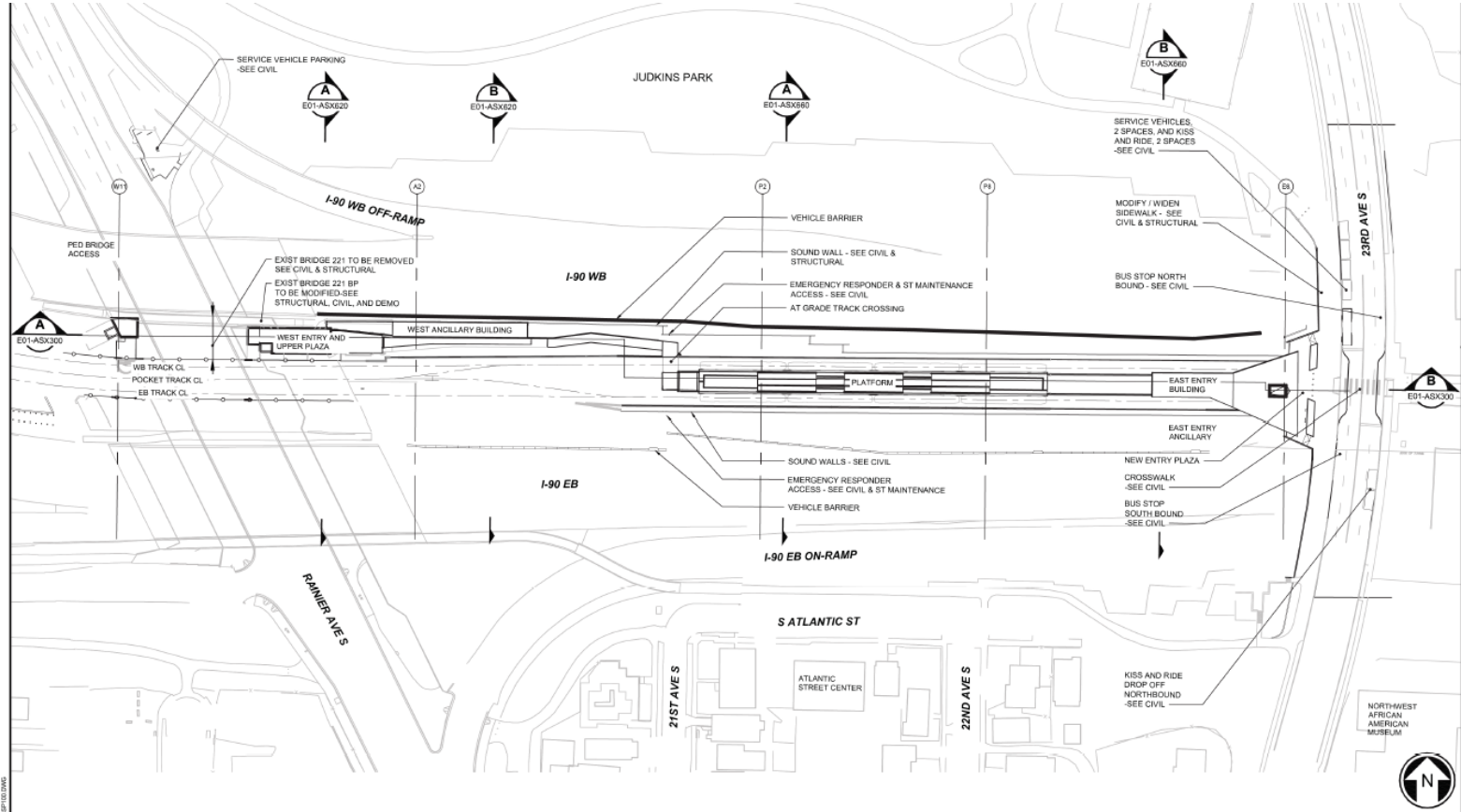



Judkins Park Station

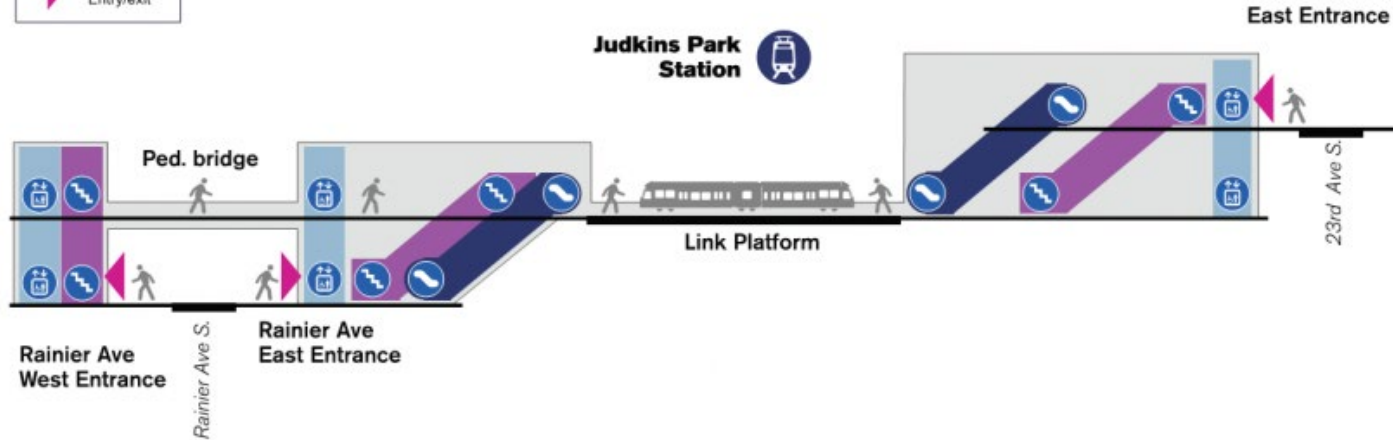

CONNECTING ROUTES
7, 9x, 106

Please note that additional information regarding para-transit locations is currently being planned. Therefore, this information has yet to be included on these station site plan and vertical circulation maps. Additionally, these maps were created during the last phase of engagement for East Link Connections and noted bus routes and stops as well as station amenities may be subject to change closer to the opening due to unforeseen factors that were not accounted for during the time period in which the maps were created.

CONNECTING ROUTES
8, 48

Graphic is not to scale



Thank you.



 [soundtransit.org](https://www.soundtransit.org)

